

Selector Valve Kit Instructions for

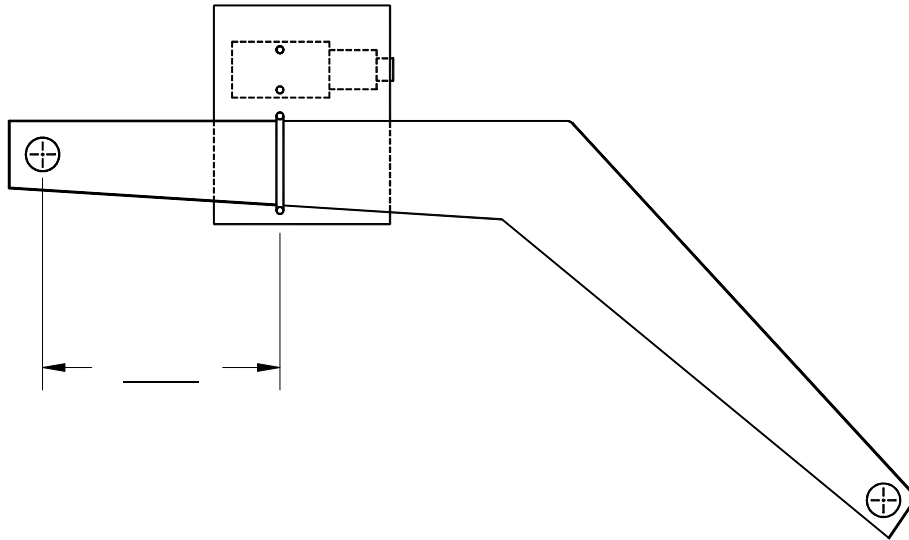

1. On the tractor side of the right hand loader arm, there are four hoses that come from the loader valve and connect onto four steel tubes that go forward down the loader arm. Mark one of the two hoses and steel tubes that go to the loader lift cylinders, so that the oil flow can be reconnected properly after the hoses have been disconnected. Disconnect the two hoses from the two steel tubes that go to the loader lift cylinders. Install the selector valve to the inside of the loader arm with the clamp rod _____ inches in front of the main pivot pin as shown above. Reconnect the two hoses to the P1 & P2 ports (bottom) on the selector valve. Connect the hoses from C1 & C4 ports (top) on the selector valve to the two steel tubes so that the oil flow is the same as before. Connect the two long hoses from C2 & C3 ports (side) on the selector valve to the tees on the back of the bucket so that when the loader lever is moved towards the rear of the tractor with the button depressed, the jaw closes.
2. Remove the knob from the loader control lever and install the hand grip from the kit. Connect the red wire on the hand grip to a hot wire on the tractor. Install the fuse assembly into the red wire at the most practical location. The black wire on the hand grip connects to one of the terminals on the solenoid. The other black wire that is in the kit connects to the other terminal on the solenoid. This is the ground wire. Route and secure wiring to minimize damage from foreign objects.
3. If your tractor has a cab check to make sure that the selector valve or bracket does not hit the cab when the loader arm is all the way up.